

Level Two

12,808 sq ft / 1,190 sq m

Terrace: 790 sq ft / 73 sq m

Workstations	96
14 person extendable boardroom	1
10 person meeting rooms	2
Hot desk areas	2
Collaboration zone	1
Lounge / breakout areas	5
Quiet rooms	6
Kitchen / breakout area	1
Reception / welcome area	1
Terrace	1



Floorplan for indicative purposes only. Not to scale.

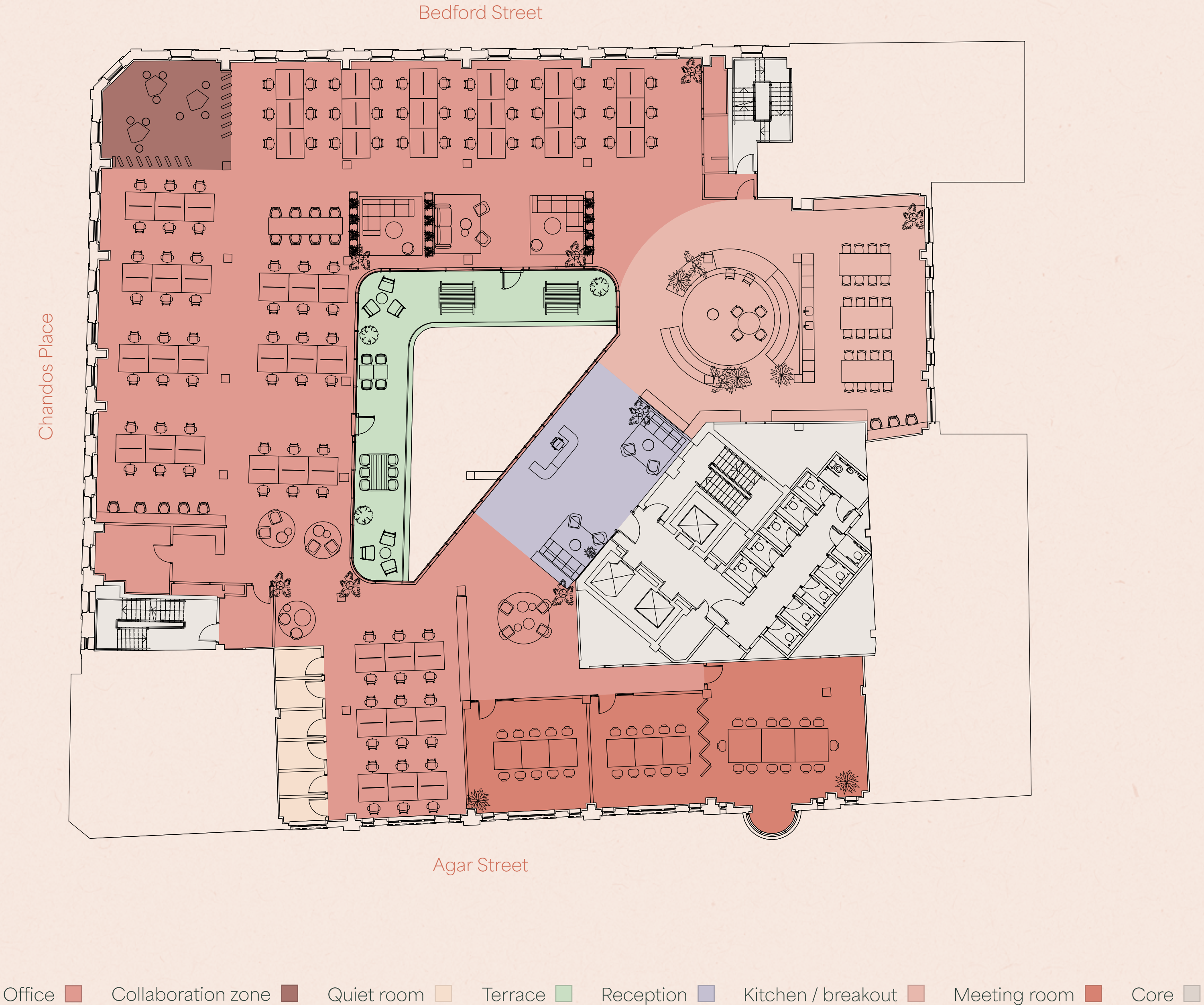

## Level Five

7,304 sq ft / 679 sq m

Terraces: 667 sq ft / 62 sq m



Floorplan for indicative purposes only. Not to scale.

